

SECHSKANT-ADAPTER MIT 60°-KONUS

HEXAGON ADAPTORS WITH 60°-CONE

Form B

Mit 60°-Konus am Außengewinde

Beide Gewinde Whitworth-Rohrgewinde - Zylindrisch
- DIN / ISO 228

Abdichtung durch Dichtkante Form B

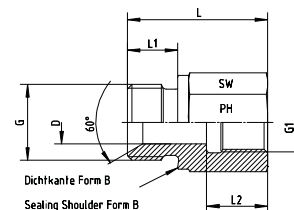

Form B

With 60°-Cone at Male Thread

Both Threads BSP - Parallel - DIN / ISO 228
Sealing by Sealing Shoulder Form B

Druck Pressure	Gewinde Thread	Ca. Maße Approx. Dimensions	Form Form	Bestellzeichen Order-Code
PN	G = BSP G1 = BSP	L L1 L2 D SW		
630	1/8"-28 1/8"-28	23,5 8,0 11,0 4,5 17	B	1050515-02-02
630	1/8"-28 1/4"-19	31,0 8,0 17,0 4,0 19	B	1050515-02-04
630	1/8"-28 3/8"-19	32,0 8,0 17,0 4,0 24	B	1050515-02-06
630	1/8"-28 1/2"-14	37,0 8,0 20,0 4,0 27	B	1050515-02-08
630	1/4"-19 1/8"-28	28,0 12,0 12,0 7,0 19	B	1050515-04-02
630	1/4"-19 1/4"-19	32,0 10,0 17,0 6,0 19	B	1050515-04-04
630	1/4"-19 3/8"-19	36,0 12,0 17,0 7,0 24	B	1050515-04-06
630	1/4"-19 1/2"-14	40,0 12,0 20,0 5,0 27	B	1050515-04-08
630	1/4"-19 3/4"-14	43,0 12,0 22,0 6,0 36	B	1050515-04-12
400	3/8"-19 1/4"-19	36,0 12,0 17,0 8,0 22	B	1050515-06-04
400	3/8"-19 3/8"-19	36,0 12,0 17,0 9,0 24	B	1050515-06-06
400	3/8"-19 1/2"-14	41,0 12,0 20,0 8,0 27	B	1050515-06-08
400	3/8"-19 3/4"-14	44,0 12,0 22,0 8,0 36	B	1050515-06-12
400	3/8"-19 1"-11	46,5 12,0 24,5 8,0 41	B	1050515-06-16
400	1/2"-14 3/8"-19	36,0 14,0 17,0 12,0 27	B	1050515-08-06
400	1/2"-14 1/2"-14	39,0 14,0 20,0 12,0 27	B	1050515-08-08
400	1/2"-14 3/4"-14	46,0 14,0 22,0 12,0 36	B	1050515-08-12
400	1/2"-14 1"-11	49,0 14,0 24,5 12,0 41	B	1050515-08-16
250	1/2"-14 1 1/4"-11	53,0 14,0 26,5 12,0 55	B	1050515-08-20
400	3/4"-14 1/2"-14	41,0 16,0 20,0 16,0 32	B	1050515-12-08
400	3/4"-14 3/4"-14	45,0 16,0 22,5 18,0 32	B	1050515-12-12
400	3/4"-14 1"-11	51,0 16,0 24,5 16,0 41	B	1050515-12-16
250	3/4"-14 1 1/4"-11	55,0 16,0 26,5 16,0 55	B	1050515-12-20
250	3/4"-14 1 1/2"-11	57,0 16,0 28,5 16,0 60	B	1050515-12-24
400	1"-11 3/4"-14	47,0 18,0 22,0 20,0 41	B	1050515-16-12
400	1"-11 1"-11	49,5 18,0 24,5 22,0 41	B	1050515-16-16
250	1"-11 1 1/4"-11	57,0 18,0 26,5 20,0 55	B	1050515-16-20
250	1"-11 1 1/2"-11	59,0 18,0 28,5 20,0 60	B	1050515-16-24
250	1 1/4"-11 1"-11	52,0 20,0 24,5 25,0 50	B	1050515-20-16
250	1 1/4"-11 1 1/4"-11	58,0 20,0 27,0 25,0 50	B	1050515-20-20
250	1 1/4"-11 1 1/2"-11	60,0 20,0 28,5 25,0 60	B	1050515-20-24
250	1 1/2"-11 1 1/4"-11	58,0 22,0 26,5 32,0 55	B	1050515-24-20
250	1 1/2"-11 1 1/2"-11	58,0 22,0 27,5 37,0 55	B	1050515-24-24
100	2"-11 2"-11	64,5 23,0 30,5 43,0 70	B	1050515-32-32