

Blanking Plug with 24° Taper / O-Ring (DKO) Type FI-VD ▪ Series L / S

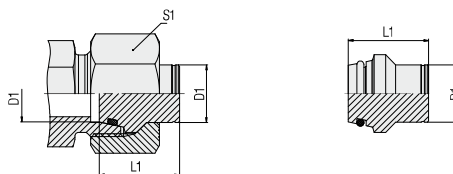

Ordering Codes

FI-VD-10*L*-B*-W3*-M

* Blanking Plug with 24° Taper / O-Ring (DKO) **FI-VD**

* Outside Tube Diameter D1 (in mm) **-10**

* Series Light Series **L**
Heavy Series **S**

* Seal Material NBR (Buna-N®) **-B**
FKM (Viton®) **-V**
EPDM **-E**

* Material Code Steel, zinc/nickel-plated **-W3**

Please contact STAUFF for alternative materials and surface finishings.

* Assembling / Kitting Blanking plug only **—**
Blanking plug supplied with union nut **-M**

Connecting Parts



Union Nut
Type **FI-M**

Page 31

Spare Parts / Accessories



O-Ring
Type **O-RING**

Page 207

Series	Tube OD (mm/in)	PN (part/ps)	Dimensions (mm/in)		Weight (% / lbs) ca. per 100 ²	Ordering Codes ³	
			D1	L1 ¹			S1
L	6	500	17	14	0,55	FI-VD-06L/S-B-W3	
	.24	7250	.67	.55	1,21	FI-VD-08L/S-B-W3	
	8	500	17	17	0,91	FI-VD-10L/S-B-W3	
	.31	7250	.67	.67	2,02	FI-VD-10L/S-B-W3	
	10	500	20	19	1,55	FI-VD-12L/S-B-W3	
	.39	7250	.79	.75	3,41	FI-VD-12L/S-B-W3	
	12	400	21	22	2,23	FI-VD-15L-B-W3	
	.47	5800	.83	.87	4,91	FI-VD-15L-B-W3	
	15	400	20	27	3,60	FI-VD-18L-B-W3	
	.59	5800	.79	1,06	7,92	FI-VD-18L-B-W3	
	18	400	21	32	4,88	FI-VD-22L-B-W3	
	.71	5800	.83	1,26	10,74	FI-VD-22L-B-W3	
	22	250	23	36	7,70	FI-VD-28L-B-W3	
	.87	3625	.91	1,42	16,94	FI-VD-28L-B-W3	
	28	250	23	41	12,00	FI-VD-35L-B-W3	
	1.10	3625	.91	1,61	26,40	FI-VD-35L-B-W3	
	35	250	29	50	24,00	FI-VD-42L-B-W3	
	1.38	3625	1,14	1,97	52,80	FI-VD-42L-B-W3	
	42	250	30	60	35,00	FI-VD-42L-B-W3	
	1.65	3625	1,18	2,36	77,00		
	S	6	800	17	17	0,55	FI-VD-06L/S-B-W3
		.24	11600	.67	.67	1,21	FI-VD-08L/S-B-W3
8		800	17	19	0,91	FI-VD-10L/S-B-W3	
.31		11600	.67	.75	20,01	FI-VD-10L/S-B-W3	
10		800	20	22	1,55	FI-VD-12L/S-B-W3	
.39		11600	.79	.87	3,41	FI-VD-12L/S-B-W3	
12		630	21	24	2,23	FI-VD-14S-B-W3	
.47		9135	.83	.94	4,91	FI-VD-14S-B-W3	
14		630	23	27	3,30	FI-VD-16S-B-W3	
.55		9135	.91	1,06	7,26	FI-VD-16S-B-W3	
16		630	24	30	4,30	FI-VD-20S-B-W3	
.63		9135	.94	1,18	9,46	FI-VD-20S-B-W3	
20		400	28	36	8,10	FI-VD-25S-B-W3	
.79		5800	1,10	1,42	17,82	FI-VD-25S-B-W3	
25		400	31	46	13,50	FI-VD-30S-B-W3	
.98		5800	1,22	1,81	29,70	FI-VD-30S-B-W3	
30		400	34	50	21,20	FI-VD-38S-B-W3	
1.18		5800	1,34	1,97	46,64	FI-VD-38S-B-W3	
38		400	38	60	36,90	FI-VD-38S-B-W3	
1.50		5800	1,50	2,36	81,18		

¹ Approximate dimension in assembled condition.

² Weight excluding union nut.

³ Standard scope of delivery: Blanking plug only.

Standard seal material is NBR (Buna-N®).

