

## Blanking Plug with 24° Taper / O-Ring (DKO) Type FI-VD ▪ Series L / S

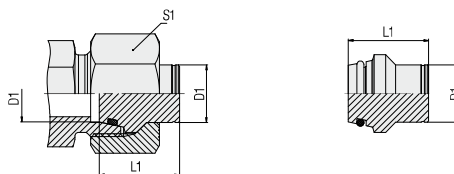

### Ordering Codes

#### \*FI-VD\*-10\*L\*-B\*-W3\*-M

\* Blanking Plug with 24° Taper / O-Ring (DKO) **FI-VD**

\* Outside Tube Diameter D1 (in mm) **-10**

\* Series Light Series **L**  
Heavy Series **S**

\* Seal Material NBR (Buna-N®) **-B**  
FKM (Viton®) **-V**  
EPDM **-E**

\* Material Code Steel, zinc/nickel-plated **-W3**

Please contact STAUFF for alternative materials and surface finishings.

\* Assembling / Kitting Blanking plug only **—**  
Blanking plug supplied with union nut **-M**

### Connecting Parts



Union Nut  
Type **FI-M**

Page 31

### Spare Parts / Accessories



O-Ring  
Type **O-RING**

Page 207

Series	Tube OD (mm/in)	PN (bar/psi)	Dimensions (mm/in)		Weight (g/lbs) ca. per 100 <sup>2</sup>	Ordering Codes <sup>3</sup>
			D1	L1 <sup>1</sup>		
L	6	500	17	14	0,55	FI-VD-06L/S-B-W3
	.24	7250	.67	.55	1,21	FI-VD-08L/S-B-W3
	8	500	17	17	0,91	FI-VD-10L/S-B-W3
	.31	7250	.67	.67	2,02	FI-VD-10L/S-B-W3
	10	500	20	19	1,55	FI-VD-12L/S-B-W3
	.39	7250	.79	.75	3,41	FI-VD-12L/S-B-W3
	12	400	21	22	2,23	FI-VD-15L-B-W3
	.47	5800	.83	.87	4,91	FI-VD-15L-B-W3
	15	400	20	27	3,60	FI-VD-18L-B-W3
	.59	5800	.79	1,06	7,92	FI-VD-18L-B-W3
	18	400	21	32	4,88	FI-VD-22L-B-W3
	.71	5800	.83	1,26	10,74	FI-VD-22L-B-W3
	.22	250	.23	.36	7,70	FI-VD-28L-B-W3
	.87	3625	.91	1,42	16,94	FI-VD-28L-B-W3
	28	250	23	41	12,00	FI-VD-35L-B-W3
	1.10	3625	.91	1,61	26,40	FI-VD-35L-B-W3
	35	250	29	50	24,00	FI-VD-42L-B-W3
	1.38	3625	1,14	1,97	52,80	FI-VD-42L-B-W3
	42	250	30	60	35,00	FI-VD-42L-B-W3
1.65	3625	1,18	2,36	77,00	FI-VD-42L-B-W3	
S	6	800	17	17	0,55	FI-VD-06L/S-B-W3
	.24	11600	.67	.67	1,21	FI-VD-08L/S-B-W3
	8	800	17	19	0,91	FI-VD-10L/S-B-W3
	.31	11600	.67	.75	20,01	FI-VD-10L/S-B-W3
	10	800	20	22	1,55	FI-VD-12L/S-B-W3
	.39	11600	.79	.87	3,41	FI-VD-12L/S-B-W3
	12	630	21	24	2,23	FI-VD-14S-B-W3
	.47	9135	.83	.94	4,91	FI-VD-14S-B-W3
	14	630	23	27	3,30	FI-VD-16S-B-W3
	.55	9135	.91	1,06	7,26	FI-VD-16S-B-W3
	16	630	24	30	4,30	FI-VD-20S-B-W3
	.63	9135	.94	1,18	9,46	FI-VD-20S-B-W3
	20	400	28	36	8,10	FI-VD-25S-B-W3
	.79	5800	1,10	1,42	17,82	FI-VD-25S-B-W3
	25	400	31	46	13,50	FI-VD-30S-B-W3
	.98	5800	1,22	1,81	29,70	FI-VD-30S-B-W3
	30	400	34	50	21,20	FI-VD-38S-B-W3
	1.18	5800	1,34	1,97	46,64	FI-VD-38S-B-W3
	38	400	38	60	36,90	FI-VD-38S-B-W3
1.50	5800	1,50	2,36	81,18	FI-VD-38S-B-W3	

<sup>1</sup> Approximate dimension in assembled condition.

<sup>2</sup> Weight excluding union nut.

<sup>3</sup> Standard scope of delivery: Blanking plug only.

Standard seal material is NBR (Buna-N®).

