

Blanking Plug for Tube Ends Type FI-VSK - Series L / S

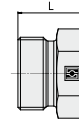
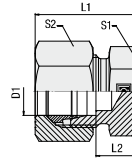

Ordering Codes

FI-VSK-10*L*-W3*-MS

| | | |
|---|---|---------------|
| * Blanking Plug for Tube Ends | | FI-VSK |
| * Outside Tube Diameter D1 (in mm) | | -10 |
| * Series | Light Series | L |
| | Heavy Series | S |
| * Material Code | Steel, zinc/nickel-plated | -W3 |
| Please contact STAUFF for alternative materials and surface finishings. | | |
| * Assembling / Kitting | Blanking plug only | — |
| | Blanking plug supplied with cutting ring and union nut | -MS |
| | Blanking plug supplied with soft-sealing cutting ring and union nut | -MSV |

Connecting Parts

| | | |
|---|--|---------|
|  | Cutting Ring Type FI-DS | Page 26 |
|  | Soft-Sealing Cutting Ring Type FI-WDDS | Page 27 |
|  | Support Sleeve Type FI-VH | Page 28 |
|  | STAUFF Form Ring Type FI-AR | Page 30 |
|  | Union Nut Type FI-M | Page 31 |
|  | 37° Flared Tube Fitting Set Type FI-AB | Page 35 |

| Series | Tube OD (mm/in) | PN (part / part) | Dimensions (mm/in) | | | | | Weight (³ lb/lb) ca. per 100 ² | Ordering Codes ³ |
|--------|--------------------|---------------------|-----------------------|-----------------|------|------|-------|---|-----------------------------|
| | | | L | L1 ¹ | L2 | S1 | S2 | | |
| L | 6 | 315 | 17 | 22 | 7 | 14 | 14 | 1,40 | FI-VSK-06L-W3 |
| | .24 | 4568 | .55 | .87 | .28 | .47 | .55 | 3,08 | |
| | 8 | 315 | 17 | 23 | 8 | 17 | 17 | 1,93 | FI-VSK-08L-W3 |
| | .31 | 4568 | .59 | .91 | .31 | .55 | .67 | 4,24 | |
| | 10 | 315 | 20 | 24 | 9 | 17 | 19 | 2,55 | FI-VSK-10L-W3 |
| | .39 | 4568 | .63 | .94 | .35 | .67 | .75 | 5,61 | |
| | 12 | 315 | 21 | 25 | 10 | 19 | 22 | 3,44 | FI-VSK-12L-W3 |
| | .47 | 4568 | .67 | .98 | .39 | .75 | .87 | 8,74 | |
| | 15 | 315 | 20 | 26 | 11 | 24 | 27 | 4,90 | FI-VSK-15L-W3 |
| | .59 | 4568 | .71 | 1,02 | .43 | .94 | 1,06 | 10,78 | |
| | 18 | 315 | 21 | 28 | 11,5 | 27 | 32 | 6,80 | FI-VSK-18L-W3 |
| | .71 | 4568 | .75 | 1,10 | .45 | 1,06 | 1,26 | 14,96 | |
| | 22 | 160 | 23 | 30 | 13,5 | 32 | 36 | 10,70 | FI-VSK-22L-W3 |
| | .87 | 2320 | .83 | 1,18 | .53 | 1,26 | 1,42 | 23,54 | |
| | 28 | 160 | 23 | 31 | 14,5 | 41 | 41 | 15,20 | FI-VSK-28L-W3 |
| | 1,10 | 2320 | .87 | 1,22 | .57 | 1,61 | 1,61 | 33,44 | |
| | 35 | 160 | 29 | 36 | 14,5 | 46 | 50 | 25,90 | FI-VSK-35L-W3 |
| | 1,38 | 2320 | .98 | 1,42 | .57 | 1,81 | 1,97 | 56,98 | |
| | 42 | 160 | 30 | 39 | 16 | 55 | 60 | 35,30 | FI-VSK-42L-W3 |
| | 1,65 | 2320 | 1,06 | 1,54 | .63 | 2,17 | 2,36 | 77,66 | |
| S | 6 | 630 | 17 | 26 | 11 | 17 | 17 | 1,80 | FI-VSK-06S-W3 |
| | .24 | 9135 | .71 | 1,02 | .43 | .55 | .67 | 3,96 | |
| | 8 | 630 | 17 | 28 | 13 | 17 | 19 | 2,16 | FI-VSK-08S-W3 |
| | .31 | 9135 | .79 | 1,10 | .51 | .67 | .75 | 4,75 | |
| | 10 | 630 | 20 | 29 | 12,5 | 19 | 22 | 3,34 | FI-VSK-10S-W3 |
| | .39 | 9135 | .79 | 1,14 | .49 | .75 | .87 | 7,35 | |
| | 12 | 630 | 21 | 31 | 14,5 | 22 | 24 | 4,60 | FI-VSK-12S-W3 |
| | .47 | 9135 | .87 | 1,22 | .57 | .87 | .94 | 10,12 | |
| | 14 | 630 | 23 | 34 | 16 | 24 | 27 | 5,88 | FI-VSK-14S-W3 |
| | .55 | 9135 | .94 | 1,34 | .63 | .94 | 1,06 | 12,94 | |
| | 16 | 400 | 24 | 34 | 15,5 | 27 | 30 | 7,54 | FI-VSK-16S-W3 |
| | .63 | 5800 | .94 | 1,34 | .61 | 1,06 | 1,18 | 16,59 | |
| | 20 | 400 | 28 | 39 | 17,5 | 32 | 36 | 12,50 | FI-VSK-20S-W3 |
| | .79 | 5800 | 1,10 | 1,54 | .69 | 1,26 | 1,42 | 27,50 | |
| | 25 | 400 | 31 | 44 | 20 | 41 | 46 | 21,40 | FI-VSK-25S-W3 |
| | .98 | 5800 | 1,26 | 1,73 | .79 | 1,61 | 1,81 | 47,08 | |
| | 30 | 400 | 34 | 47 | 20,5 | 46 | 50 | 30,40 | FI-VSK-30S-W3 |
| | 1,18 | 5800 | 1,34 | 1,85 | .81 | 1,81 | 1,97 | 76,20 | |
| 38 | 315 | 38 | 54 | 23 | 55 | 60 | 40,80 | FI-VSK-38S-W3 | |
| 1,50 | 4568 | 1,54 | 2,13 | .91 | 2,17 | 2,36 | 89,76 | | |

¹ Approximate dimension in assembled condition.

² Weight excluding cutting ring and union nut.

³ Standard scope of delivery: Blanking plug only.

