

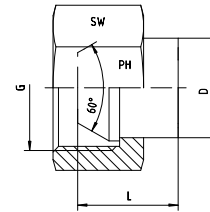

Für BSP-Gewinde mit 60°-Innenkonus
Verschluss - DKR

For BSP-Thread with 60°-Cone



Druck Pressure	Gewinde Thread	Ca. Maße Approx. Dimensions		Bemerkungen Notes		Bestellzeichen Order-Code
PN	G = BSP	L	D	SW		
400	1/8"-28	11	12,0	14		1050513-02
400	1/4"-19	15	9,0	17		1050513-04
400	3/8"-19	15	12,4	19		1050513-06
400	1/2"-14	17	16,4	27		1050513-08
400	5/8"-14	16	22,0	27		1050513-10
400	3/4"-14	19	21,3	32		1050513-12
400	1"-11	20	27,8	41		1050513-16
200	1 1/4"-11	22	36,0	50		1050513-20
200	1 1/2"-11	25	45,0	55		1050513-24
100	2"-11	31	54,5	70		1050513-32