

MALE X MALE ADAPTORS  
ADATTATORI MASCHIO X MASCHIO

## GIG

MALE BSPP X MALE BSPP, 60° CONE  
MASCHIO BSPP X MASCHIO BSPP, CONO 60°

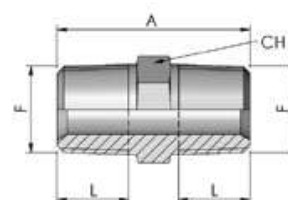

MALE X MALE ADAPTORS  
ADATTATORI MASCHIO X MASCHIO

## GIGCON

MALE BSPT X MALE BSPT, 60° CONE  
MASCHIO BSPT X MASCHIO BSPT, CONO 60°

Notes

\* DIN version

Code Article Codice Articolo	Thread Filetto	Dimensions (mm) Dimensioni (mm)		
		CH	A	L
	F	CH	A	L
GIG02	1/8-28	14	22,2	8
GIG04	1/4-19	19	31,2	12
GIG06	3/8-19	22	32,4	12
GIG08	1/2-14	27	37,6	14
GIG10	5/8-14	30	42,6	16
GIG12	3/4-14	32	42,8	16
GIG16	1"-11	41	48	18
GIG20*	1 1/4-11	50	59	20
GIG24*	1 1/2-11	55	64	22
GIG32*	2"-11	70	69	24
GIG40	2 1/2-11	75	63	25
GIG48	3"-11	90	68	26

Note

\* Versione DIN

Notes

Note

Code Article Codice Articolo	Thread Filetto	Dimensions (mm) Dimensioni (mm)		
		CH	A	L
	F	CH	A	L
GIGCON02	1/8-28	14	26	10
GIGCON04	1/4-19	17	32,5	13
GIGCON06	3/8-19	19	37,5	15
GIGCON08	1/2-14	24	44	18
GIGCON12	3/4-14	30	49	20
GIGCON16	1"-11	36	59	24,5
GIGCON20	1 1/4-11	45	63	26
GIGCON24	1 1/2-11	50	64	26,5
GIGCON32	2"-11	65	68	28