

CONNECTORS  
PROLUNGHE

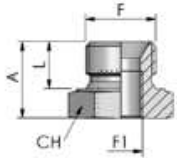

## RMN

BSPP REDUCER BSPP MALE 60° CONE X BSPP FEMALE  
RIDUZIONE MEZZO NIPPLE BSPP, CONO 60°

Code Article Codice Articolo	Thread Filetto		Dimensions (mm) Dimensioni (mm)		
	F	F1	CH	A	L
RMN0402	1/4-19	1/8-28	19	17,8	11,2
RMN0602	3/8-19	1/8-28	22	21,3	13,6
RMN0604	3/8-19	1/4-19	22	19,7	12
RMN0804	1/2-14	1/4-19	27	23,6	14,8
RMN0806	1/2-14	3/8-19	27	23,6	14,8
RMN1204	3/4-14	1/4-19	32	26,9	17
RMN1206	3/4-14	3/8-19	32	25,9	16
RMN1208	3/4-14	1/2-14	32	26	16
RMN1218*	3/4"-14	M18x1,5	32	25,3	17,5
RMN1602*	1"-11	1/8-28	41	30	19
RMN1604	1"-11	1/4-19	41	31,3	20,3
RMN1606	1"-11	3/8-19	41	31,3	20,3
RMN1608	1"-11	1/2-14	41	31,3	20,3
RMN1612	1"-11	3/4-14	41	31,3	20,3
RMN2012	1"1/4-11	3/4-14	50	36	20
RMN2016	1"1/4-11	1"-11	50	36	20
<b>RMN2416</b>	<b>1"1/2-11</b>	<b>1"-11</b>	<b>55</b>	<b>36,8</b>	<b>22</b>
RMN2420	1"1/2-11	1"1/4-11	55	36,8	22
RMN3216	2"-11	1"-11	70	40	24
RMN3220	2"-11	1"1/4-11	70	40	24
RMN3224	2"-11	1"1/2-11	70	40	24

Notes

\* WHILE STOCKS LAST

Note

\* ARTICOLO IN ESAURIMENTO

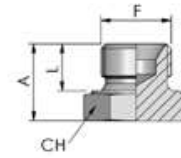

PLUGS  
TAPPI MASCHIO

## TMG

BSPP PLUG, 60° CONE  
TAPPO MASCHIO BSPP, CONO 60°

Code Article Codice Articolo	Thread Filetto	Dimensions (mm) Dimensioni (mm)		
	F	CH	A	L
TMG02	1/8-28	14	15,7	9,4
TMG04	1/4-19	19	17,8	11,2
TMG06	3/8-19	22	21,3	13,6
TMG08	1/2-14	27	23,6	14,8
TMG10	5/8-14	30	25,8	16
TMG12	3/4-14	32	25,9	16
TMG16	1"-11	41	29	18
TMG20	1"1/4-11	50	36,5	22
TMG24	1"1/2-11	55	36,8	22
TMG32	2"-11	70	40	24
TMG40	2"1/2-11	75	38	25

Notes

Note